

**FUSIBILI EXTRARAPIDI TIPO D1****D1 TYPE HIGH SPEED FUSES****Caratteristiche generali:**

- Tipo prodotto: fusibili a corpo quadro serie A-69ET;
- Tipologia: fusibili con interasse di fissaggio 110 mm (D1);
- Tensione nominale: 690V AC;
- Dimensioni: A1, A2 e A3;
- Caratteristica d'intervento: aR;
- Conformi alle norme: CEI 32-1, CEI 32-7, IEC 60269-1, IEC 60269-4, DIN 43653;
- Corpo in steatite;
- Contatti in rame argentato;
- Corrente nominale: da 80A a 1400A;
- Potere di interruzione: 200kA;
- Confezione minima: 1 pezzo;

**General characteristics:**

- *Product type: square body A-69ET fuses;*
- *Types: fuses with 110 mm distance between fixing holes (D1);*
- *Rated voltage: 690V AC;*
- *Dimensions: A1, A2 and A3;*
- *Time-current characteristic: aR;*
- *Conform to: CEI 32-1, CEI 32-7, IEC 60269-1, IEC 60269-4, DIN 43653;*
- *Steatite body;*
- *Silver plated copper contacts;*
- *Rated current: from 80A to 1400A;*
- *Breaking capacity: 200kA;*
- *Minimum packaging: 1 piece;*

**Foto dei prodotti / Products images**

Pagine totali del documento: 7

Document total pages: 7

Ultimo aggiornamento: 29 Gennaio 2015

Last updated: 29th January 2015

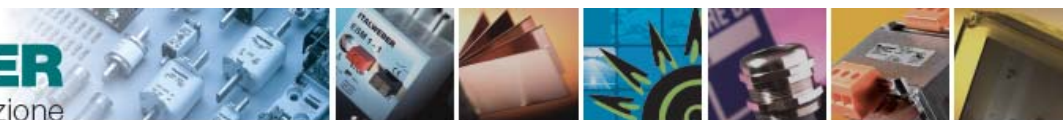

**Codici e caratteristiche principali:**

**Codes and basic characteristics:**

grandezza	tipo D1 – Interasse fissaggio 110 mm con indicatore visivo	tipo D1 – Interasse fissaggio 110 mm con percussore centrale (1)	In (A)	Vn (V)	caratteristica	conf.
size	type D1 – 110 mm mounting distance with visual indicator	type D1 – 110 mm mounting distance with centre trip indicator (1)			characteristic	pack.
A1-69ET	1747080A	1747080T	80	690	aR	3
	1747100A	1747100T	100	690	aR	3
	1747125A	1747125T	125	690	aR	3
	1747160A	1747160T	160	690	aR	3
	1747200A	1747200T	200	690	aR	3
	1747250A	1747250T	250	690	aR	3
	1747315A	1747315T	315	690	aR	3
	1747350A	1747350T	350	690	aR	3
	1747400A	1747400T	400	690	aR	3
	1747500A	1747500T	500	690	aR	3
	1747630A	1747630T	630	690	aR	3
A2-69ET	1747710A	1747710T	710	690	aR	3
	1748630A	1748630T	630	690	aR	3
	1748710A	1748710T	710	690	aR	3
	1748800A	1748800T	800	690	aR	3
	1748900A	1748900T	900	690	aR	3
A3-69ET	1748910A	1748910T	1000	690	aR	3
	1749900A	1749900T	900	690	aR	3
	1749980A	1749980T	1100	690	aR	3
	1749990A	1749990T	1250	690	aR	3
	1749994A	1749994T	1400	690	aR	3

(1) Microinterruttore opzionale codice 1750011 (più adattatore 1750005)

(1) Optional microswitch code 1750011 (plus adapter 1750005)



**Disegno (dimensioni in mm):**

**Drawing (dimensions in mm):**

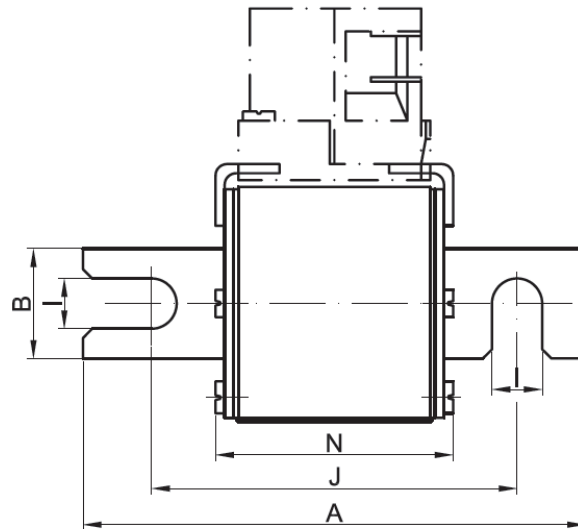
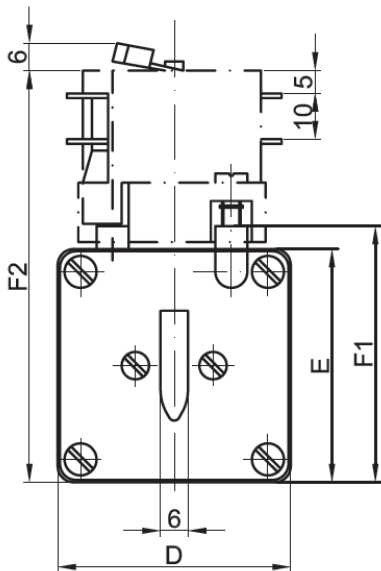
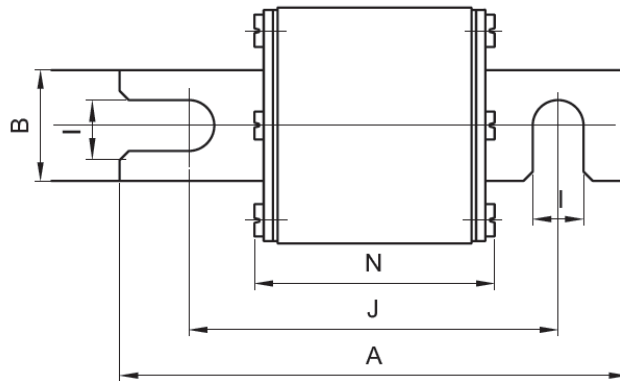
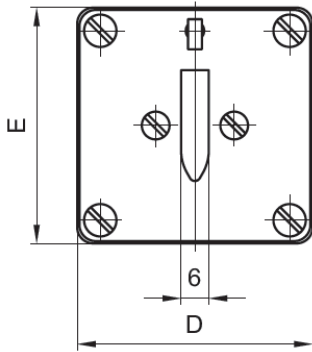

grand. - size	A	B	D	E	F1	F2	I	J	N
1	140	24	51	51	56	90	11	110	52
2	140	30	60	60	65	99	11	110	52
3	140	37	75	75	80	114	11	110	52



## Altre caratteristiche

## Other characteristics

grandezza - size	$I_n$ (A)	$P_w$ (W)	$I^2t$ total (A <sup>2</sup> s)	$I_k$ (kA)
<b>A1-69ET</b>	80	16	2.300	200
	100	20	4.600	200
	125	25	6.600	200
	160	32	10.000	200
	200	40	18.000	200
	250	50	32.000	200
	315	60	58.000	200
	350	63	78.000	200
	400	66	110.000	200
	500	73	200.000	200
	630	86	330.000	200
<b>A2-69ET</b>	710	92	470.000	200
	630	85	310.000	200
	710	91	460.000	200
	800	95	720.000	200
	900	115	920.000	200
<b>A3-69ET</b>	1000	124	1.300.000	200
	900	115	920.000	200
	1000	131	1.000.000	200
	1100	140	1.500.000	200
	1250	152	2.300.000	200
	1400	156	2.600.000	200



**Curve caratteristiche tempo / corrente  
Tipo A1-69ET**

**Time / current characteristic curves  
A1-69ET type**

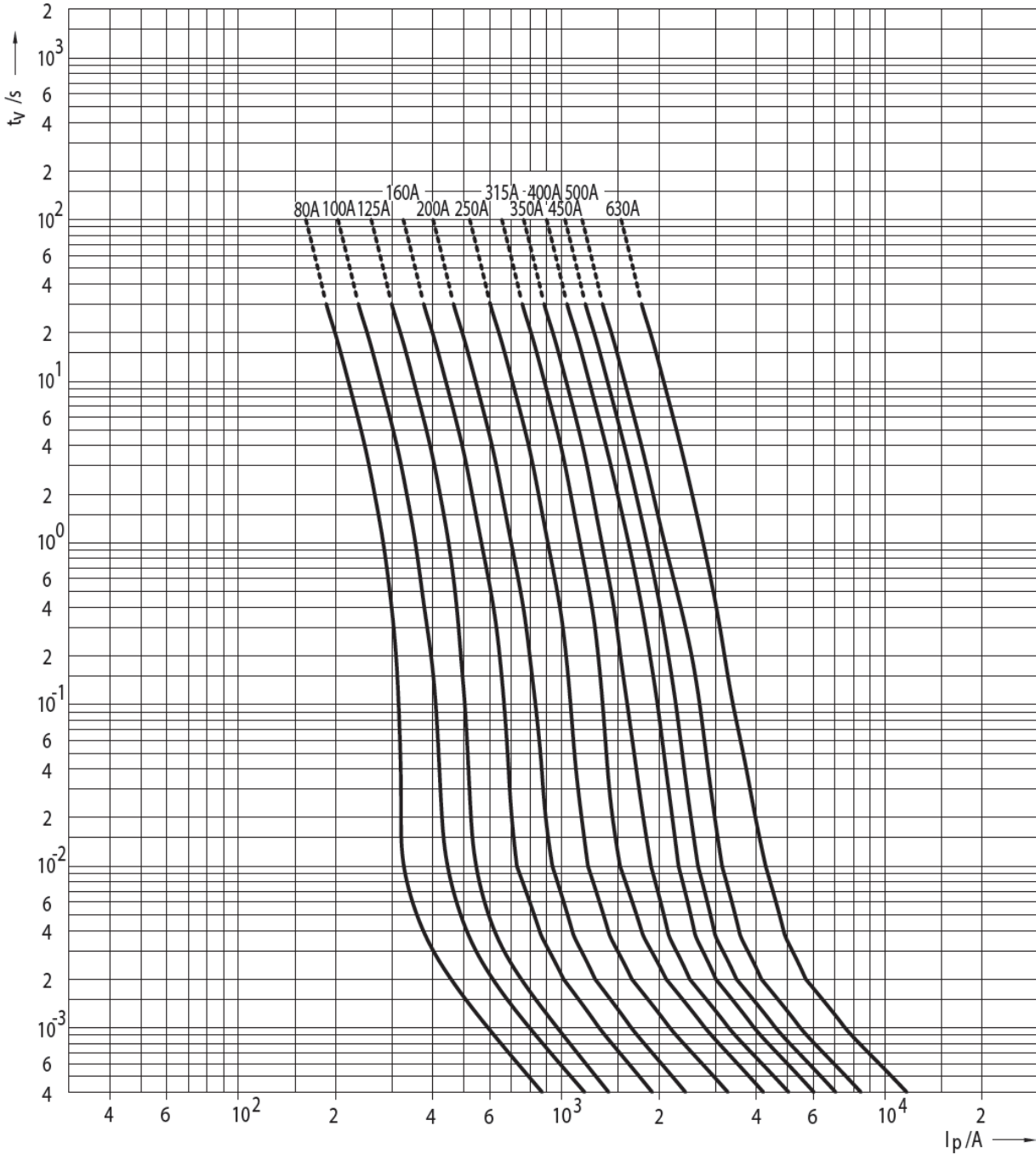



**Curve caratteristiche tempo / corrente  
Tipo A2-69ET**

**Time / current characteristic curves  
A2-69ET type**

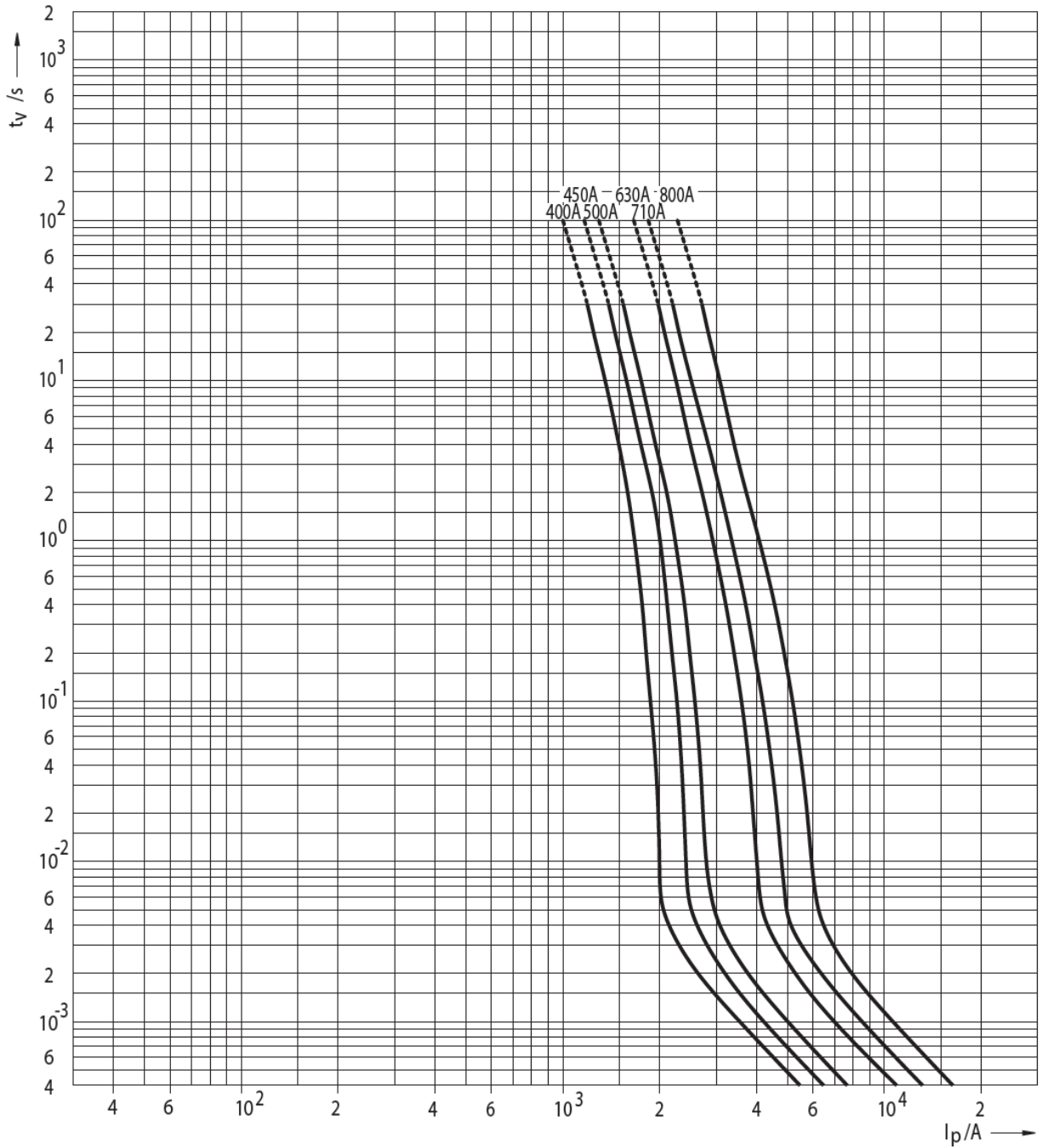





**Curve caratteristiche tempo / corrente  
Tipo A3-69ET**

**Time / current characteristic curves  
A3-69ET type**

